

Single Specification		
Product Name		Sealed Nickel Cadmium Cylindrical Rechargeable Battery
Model		EJD-2/3AAA200
Nominal Voltage		1.2V
Nominal Capacity		200mAh
Dimension (with tube)	Diameter	10.5 ⁺⁰ _{-0.5}
	Height	29.0 ⁺⁰ _{-1.0}
Internal Resistance at 1000Hz		≤70m Ω (After charge)
Charge	Standard	20mA×16h
	Rapid	200mA×90min
	Trickle	6~10mA
Discharge Cut-off Voltage		1.0V
Cycle Life		≥ 500 Cycles
Ambient Temperature	Standard Charge	0°C to 45°C
	Rapid Charge	10°C to 40°C
	Trickle Charge	0°C to 45°C
	Discharge	-20°C to 50°C
	Storage	-20°C to 45°C
Ambient Humidity		65±20%

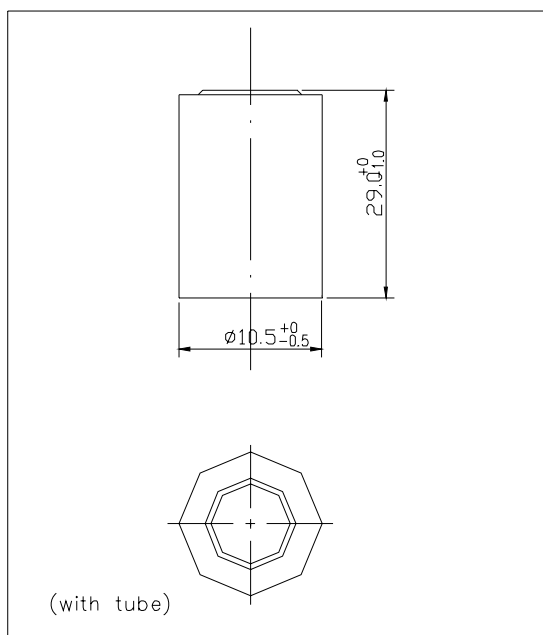

General Characteristics

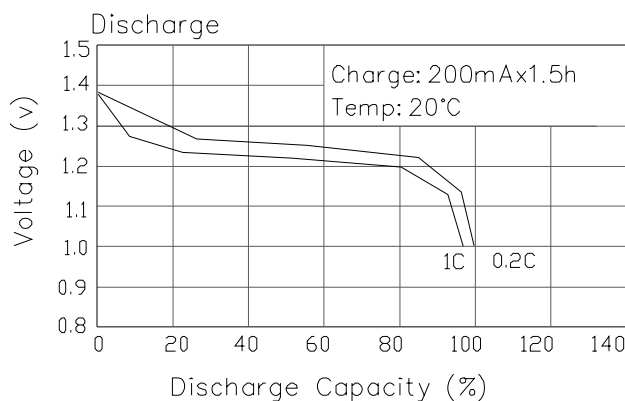
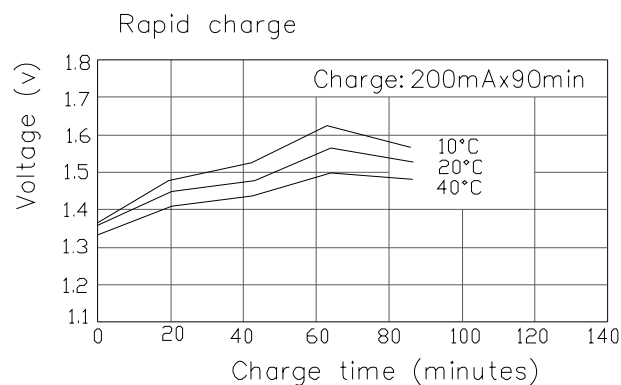
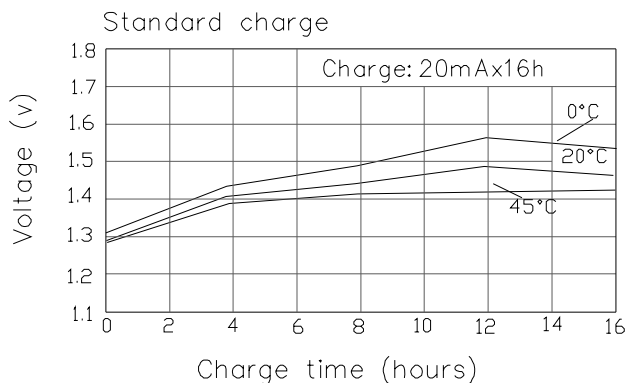

Manufacturer reserves the right to alter or amend the approval sheet without the prior notice