

Single Specification		
Product Name	Sealed Nickel Cadmium Cylindrical Rechargeable Battery	
Model	<b>EJD-2/3AAA250</b>	
Nominal Voltage	1.2V	
Nominal Capacity	250mAh	
Dimension (with tube)	Diameter	10.5 <sup>+0</sup> <sub>-0.5</sub>
	Height	29.0 <sup>+0</sup> <sub>-1.0</sub>
Internal Resistance at 1000Hz	≤70m Ω (After charge)	
Charge	Standard	25mA×16h
	Rapid	250mA×90min
	Trickle	7.5~12.5mA
Discharge Cut-off Voltage	1.0V	
Cycle Life	≥ 500 Cycles	
Ambient Temperature	Standard Charge	0°C to 45°C
	Rapid Charge	10°C to 40°C
	Trickle Charge	0°C to 45°C
	Discharge	-20°C to 50°C
	Storage	-20°C to 45°C
Ambient Humidity	65±20%	

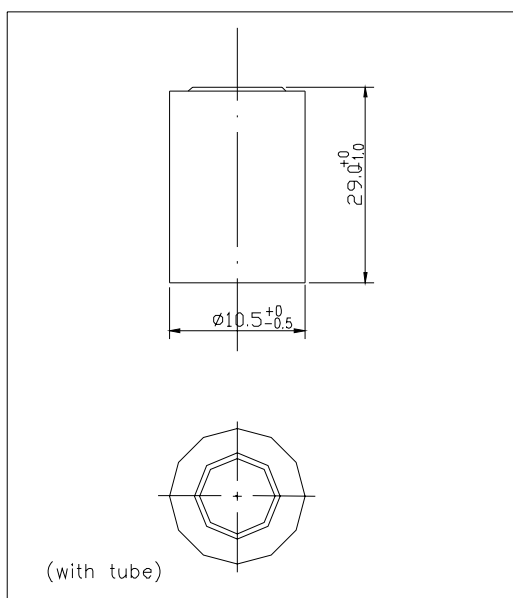

### General Characteristics

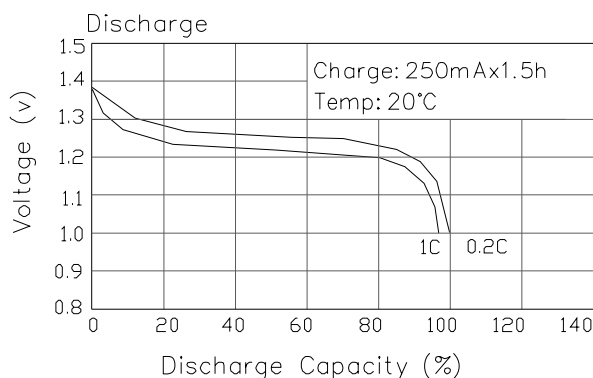
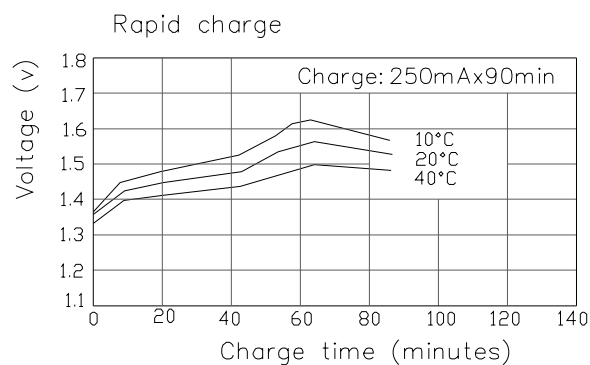
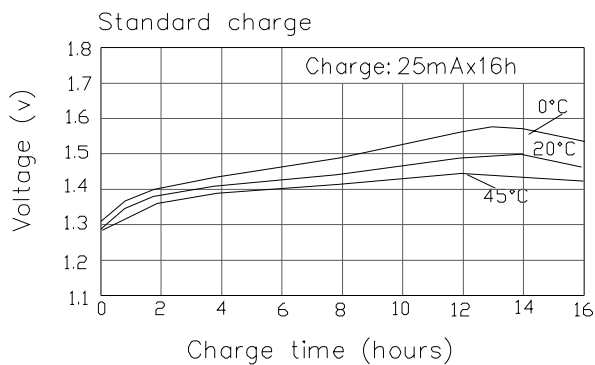

Manufacturer reserves the right to alter or amend the approval sheet without the prior notice