

Single Specification		
Product Name	Sealed Nickel Cadmium Cylindrical Rechargeable Battery	
Model	<b>EJD-C2500HT</b>	
Nominal Voltage	1.2V	
Nominal Capacity	2500mAh	
Dimension (with tube)	Diameter	25.8 <sup>+0</sup> <sub>-1.0</sub>
	Height	50.0 <sup>+0</sup> <sub>-1.0</sub>
Internal Resistance at 1000Hz (After charge)		≤ 10mΩ
Charge	Standard	250mA × 16h
	Rapid	-----
	Trickle	75~125mA
Discharge Cut-off Voltage		1.0V
Cycle Life		≥ 500 Cycles
Ambient Temperature	Standard Charge	0°C to 70°C
	Rapid Charge	-----
	Trickle Charge	0°C to 70°C
	Discharge	-20°C to 70°C
	Storage	-20°C to 45°C
Ambient Humidity		65±20%

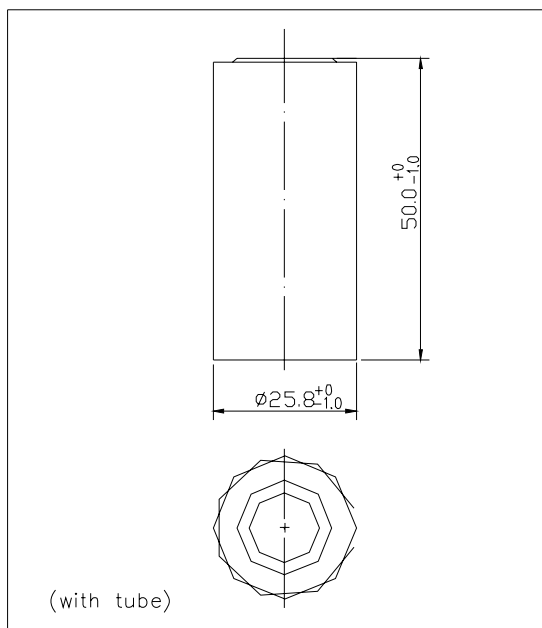

### General Characteristics

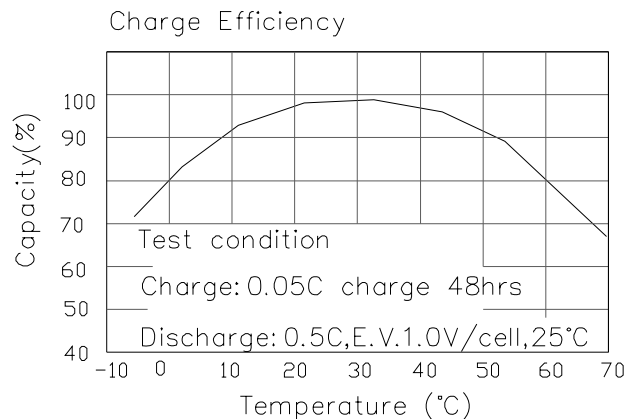
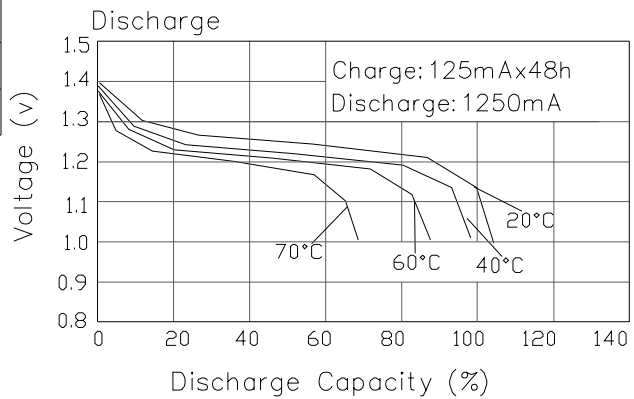
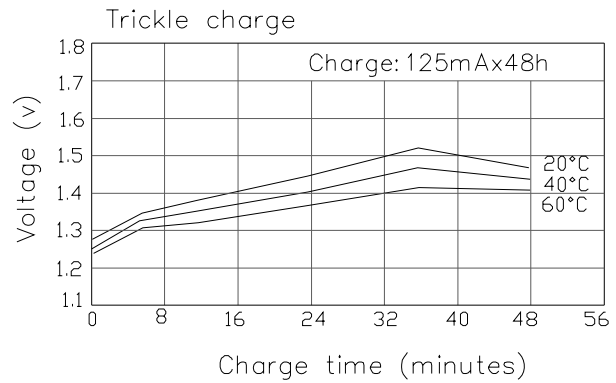
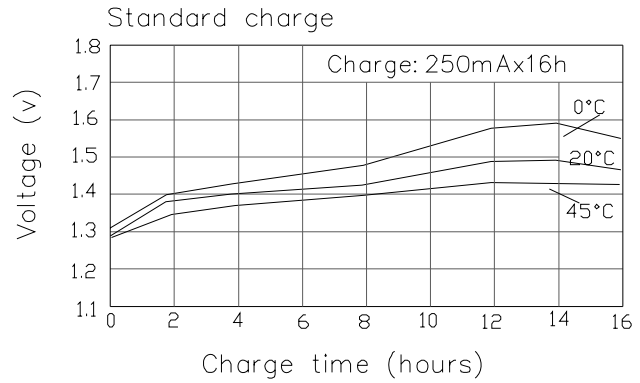

Manufacturer reserves the right to alter or amend the approval sheet without the prior notice